

Santa Cecilia in Trastevere Plan

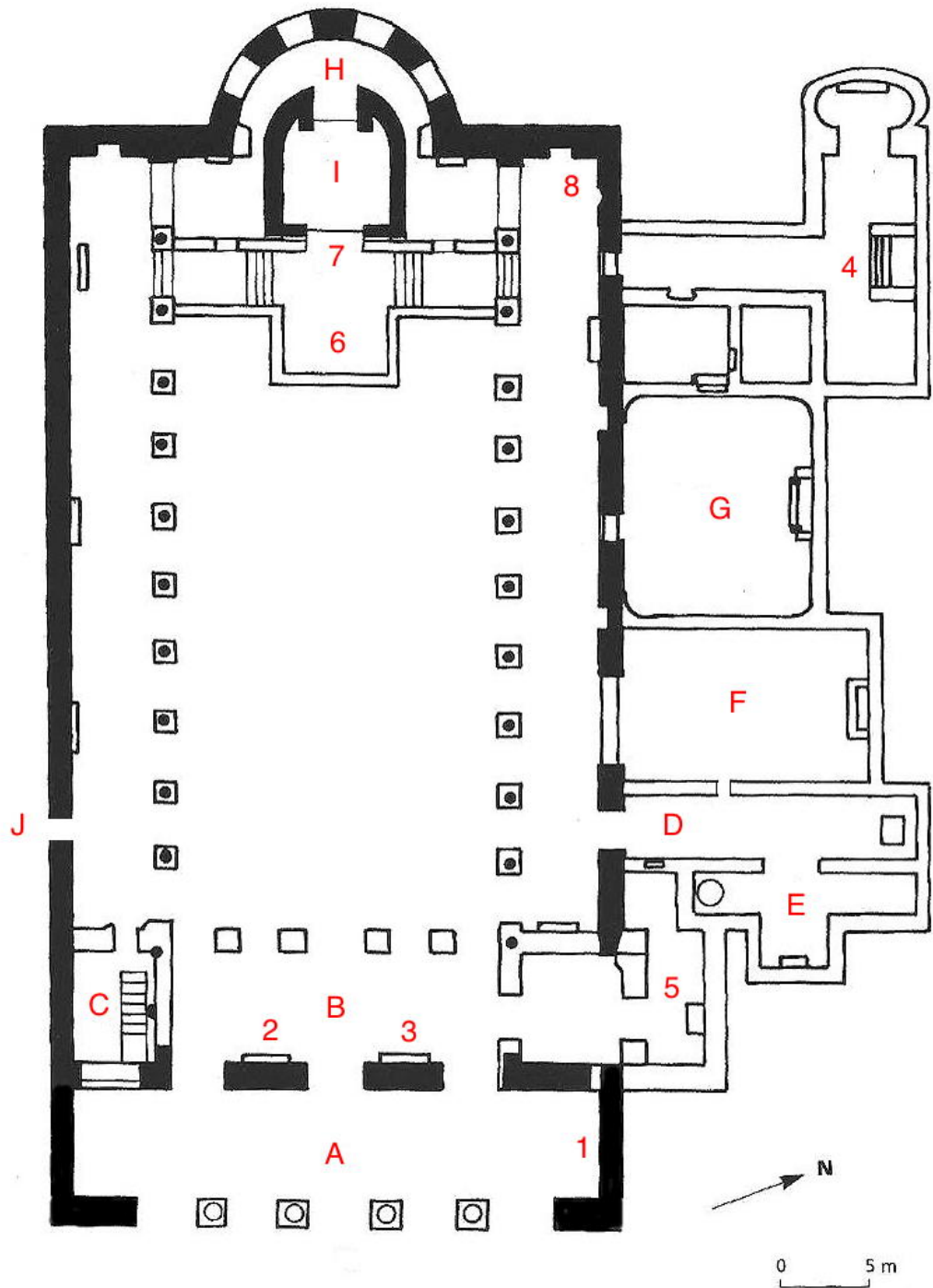

- A. Portico (12th C.)
 - B. Entrance Vestibule
 - C. Sacristy (entrance to the Roman buildings)
 - D. Corridor
 - E. Calidarium
 - F. Chapel of the Holy Sacrament: frescos (15th & 16th C.) (former Ponziani Chapel)
 - G. Relic Chapel
 - H. Apse: mosaic (9th C.)
 - I. Semi-Annular Crypt (9th C.)
 - J. Entrance to enclosed convent of Benedictine nuns
-
- 1. Tomb of Cardinal Sfondrati
 - 2. Monument to Cardinal Forteguerri, by Mino da Fiesole
 - 3. Monument to Cardinal Adam of Eaton, Hertford
 - 4. Tomb of Cardinal M. Rampoila del Tindaro
 - 5. *Crucifixion* fresco (13th C.)
 - 6. Below altar: statue of *St. Cecilia*
 - 7. Tabernacle, by Arnolfo di Cambio (13th C.)
 - 8. *Finding the Body of St. Cecilia*, fresco (12th C.)